

(Pennsylvania - Potter.

2232

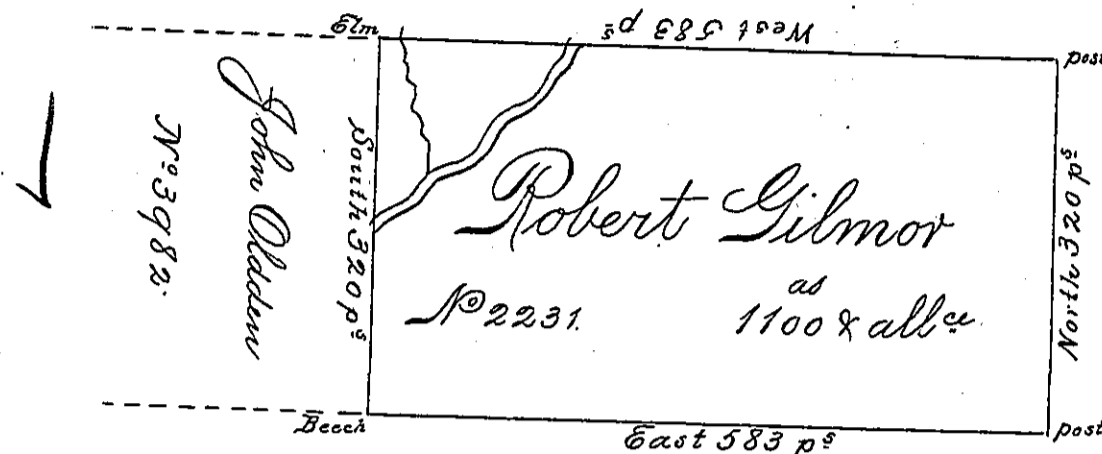

2216

2226

In pursuance of a warrant No 2231 dated December 12th 1792 Survey^d June 12th 1793 to Robert Gilmor the above described tract of Land situated on a branch of the Sinnemahoning and adjoining Lands of John Olden in the late purchase Northumberland County in District No 2 containing Eleven hundred acres and allowance of Six p^{ts} Cent

J. M. Brodhead D.S.

IN TESTIMONY that the above is a copy of the original remaining on file in the Department of Internal Affairs of Pennsylvania, made conformably to an Act of Assembly approved the 16th day of February, 1833, I have hereunto set my Hand and caused the Seal of said Department to be affixed at Harrisburg, this *fourth* day of *October* 1898.

James W. Latta
Secretary of Internal Affairs.